

# Axkid NEXTKID Rehab US



## Instructions for Use

Axkid NEXTKID Rehab US Special Needs Booster Seat

Use **ONLY** with disabled persons who weigh between 40 lbs and 110.2 lbs (18.2 - 50 kg) **AND** whose height is between 43.4" and 59" (110.1 - 150 cm)



READ INSTRUCTION MANUAL before using this child restraint



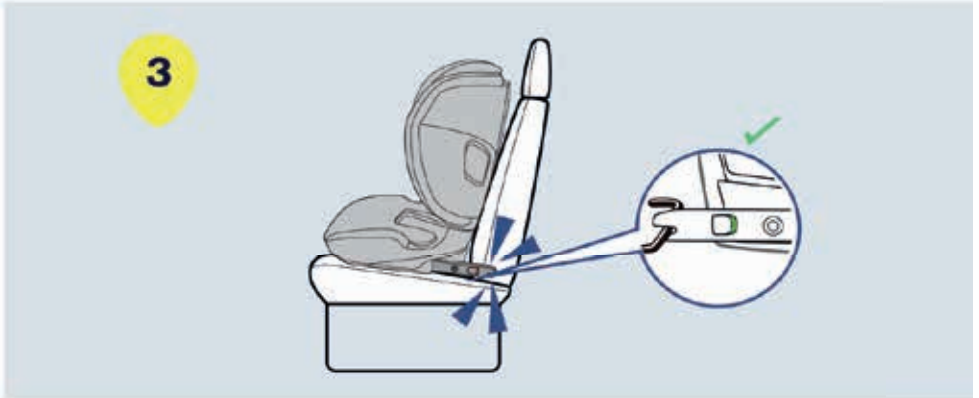
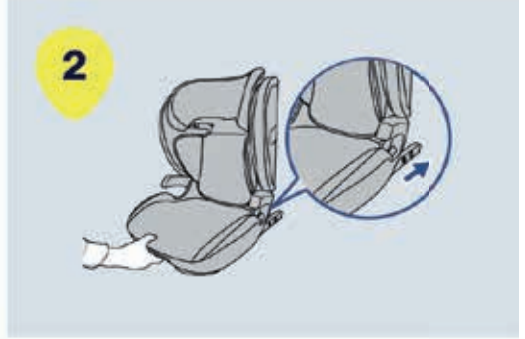

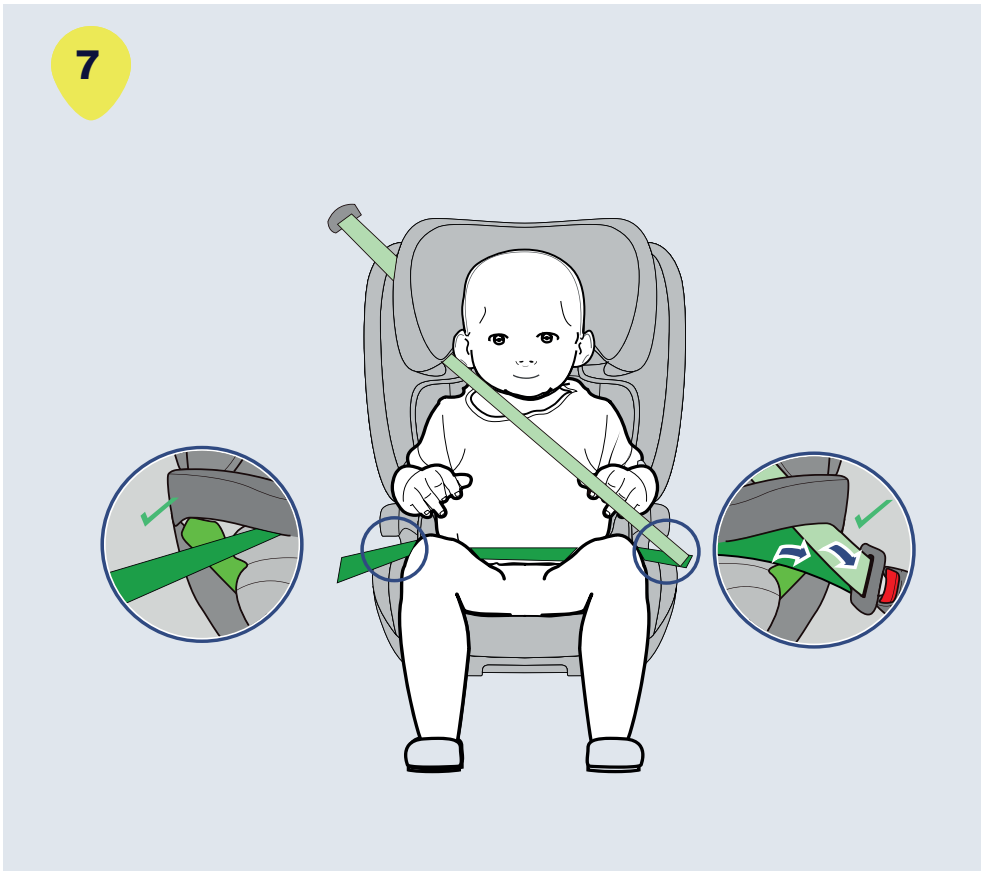
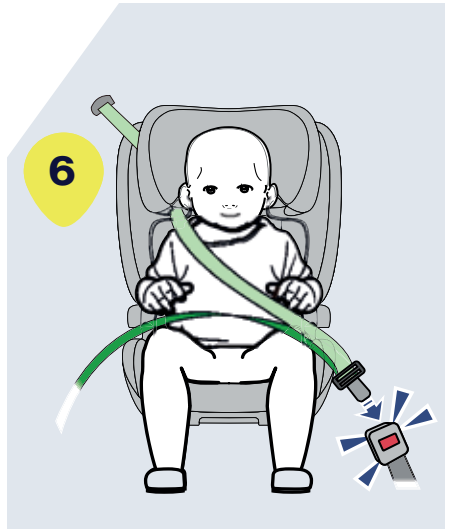
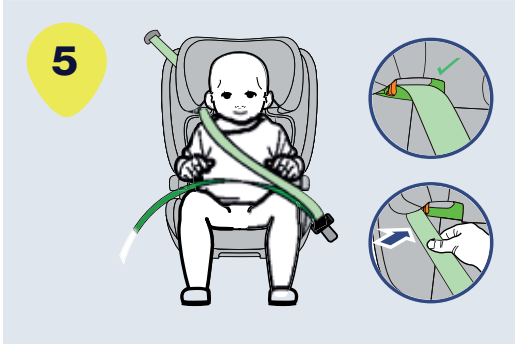

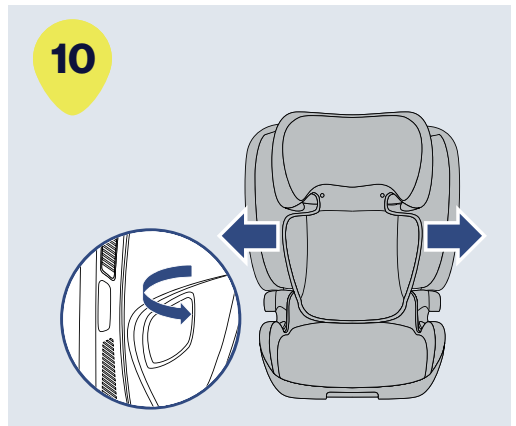
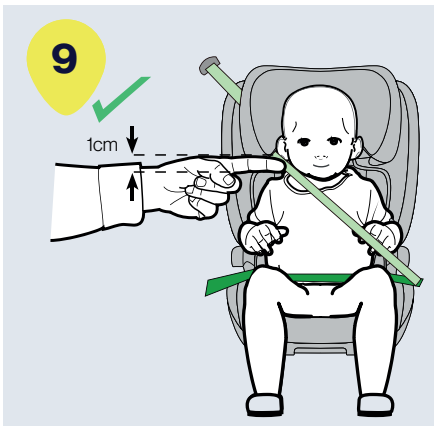
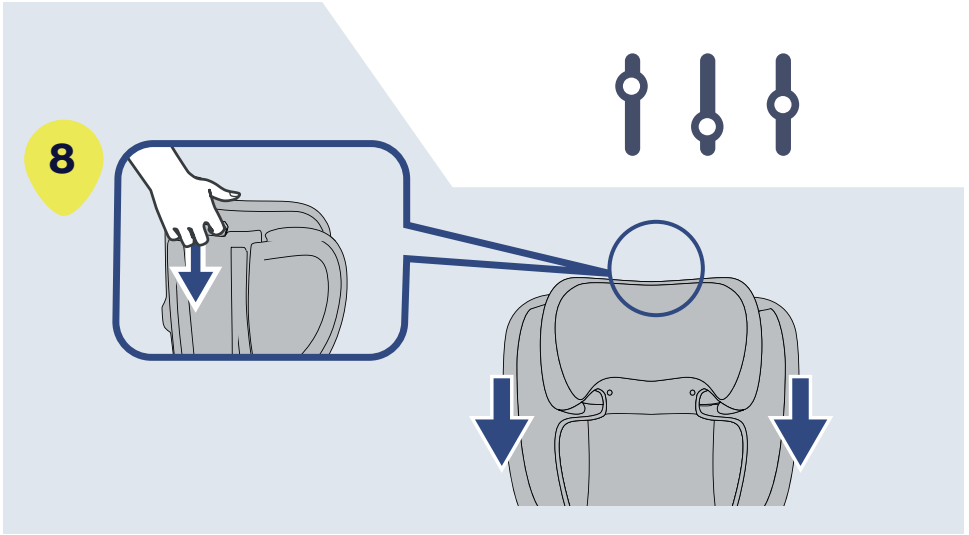

## Parts

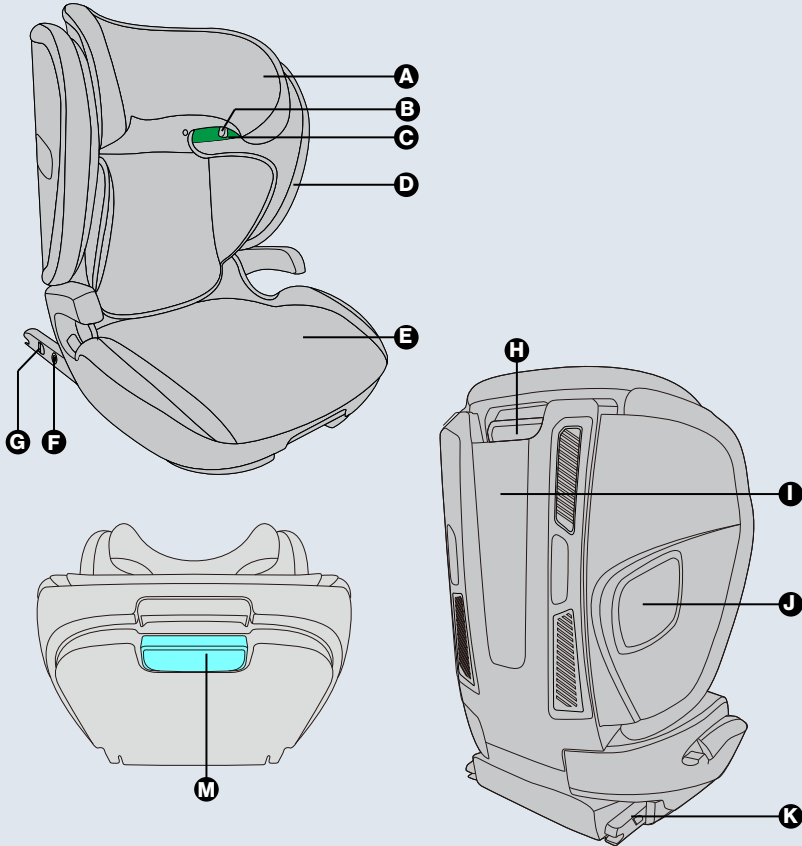

A	Head rest	H	Headrest height adjusting handle
B	Shoulder strap guide hook Unlocking part	I	Backrest
C	Shoulder strap guide hook	J	SIP Bumper Controller
D	Side wings	K	LATCH
E	Base	M	LATCH release handle
F	LATCH unlocking device		
G	LATCH dual locking button		





1-1



2-1



3-1



4-1



5-1



6-1



7-1



8-1



9-1



10-1 (Fig. above), 11-1 (Fig. below)



12



13



14



15



16



17



18



19



20



21



22



23



24



25



26



27



28



29



30



31



32



33



34



35

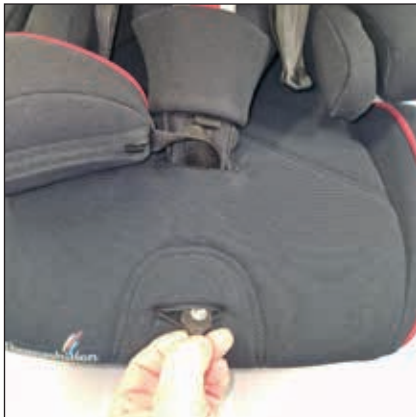

36



37



### Welcome to the Thomashilfen family!

To make handling of your new child car seat safe, practical, and comfortable for both you and your child, please read all instructions and warnings before use.

**PLEASE NOTE:** User manual is stored in a transparent pocket at the backrest of Nextkid seat. Always keep the manual in the pocket on the back of the booster seat.

Should you have further questions or problems, please contact your specialist dealer or us directly. Our address:



#### Exomotion LLC dba Thomashilfen

14221 29th ST. E ste 101

Sumner WA 98390

Phone: 866-870-2122

email: info@thomashilfen.com

www.thomashilfen.us

We reserve the right to make technical changes. This can lead to differences between your product and how it is presented in brochures and other media.

## Table of Contents

Figures . . . . .	2
Welcome to the Thomashilfen family . . . . .	14
Registration information . . . . .	16
Intended Purpose . . . . .	17
— Intended Use / Application Areas . . . . .	17
— Indication / Patient Target Group / Intended Users . . . . .	17
— Risks Associated with Use and Contraindications . . . . .	17
Labels / Model Identification . . . . .	18
Warnings and Safety Information . . . . .	21
Certifications. . . . .	21
Safety Instructions. . . . .	21
Warnings. . . . .	22
— Vehicle Seat Location. . . . .	22
— Vehicle Seat Belt Systems . . . . .	23
Installation in the vehicle. . . . .	24

Securing a child in the booster seat . . . . .	27
Removing child from booster seat . . . . .	27
Seat adjustments . . . . .	28
Removing the booster seat out of your vehicle. . . . .	28
Product Description . . . . .	28
— Scope of Delivery / Standard Equipment . . . . .	28
— Booster Assembly. . . . .	28
Technical Data . . . . .	30
Accessories. . . . .	30
Cleaning, Care Instructions, and Disinfection on a Daily Basis. . . . .	33
— Spare Parts . . . . .	33
— Storage / Disposal . . . . .	34
— Technical standards and CE marking . . . . .	34
Warranty . . . . .	34
Period of Use / Service Life . . . . .	35
Distributor . . . . .	35

## Registration information

Register your new car seat. Restraints could be recalled for safety reasons. You must register this restraint to be reached in a recall. Send your name, address, email address if available, and the restraint's model name, manufacturing date and serial number to:

### Thomashilfen NorthAmerica

14221 29th St E, #101 • Sumner, WA 98390 • USA

or call: 866 870 2122 (toll free)

or register online at: [www.thomashilfen.us/registry-us](http://www.thomashilfen.us/registry-us)



For recall information, call the U.S. Government's Vehicle Safety Hotline at 1-888- 327-4236 (TTY: 1-800-424-9153) or go to [www.NHTSA.gov](http://www.NHTSA.gov).

Please fill in the information below for future reference. The model number/ serial number and manufacturing date can be found on label on the backrest below storage pocket for instruction manual.

Model/ Serial Number:

Manufacture Date:

Date of Purchase:

### Contact a Child Passenger Safety (CPS) technician

You can find a CPS technician in your area at <https://www.nhtsa.gov/equipment/car-seats-and-booster-seats#installation-help-inspection>

## Intended Purpose

### Intended Use / Application Areas

Nextkid US Special Needs Booster Seat is designed to safely transport and proper position disabled children who weigh between **40 and 110.2 lbs (18.2 - 50kg)** **AND whose height is between 43.4 and 59" (110.1 — 150cm)** in vehicles. The seat is always secured by using the vehicle's lap and shoulder seat belt. The non load bearing positioning harness (5-point positioning harness) is designed to position and support the passenger in an upright sitting position only.

Nextkid provides additional support to help the passenger sit securely, stabilizes head control, and offers secure seating for the hip area. The seat can be adjusted to the growth of the user or the physique of different users by adjusting headrest height. In addition, the product offers a wide range of accessories for customized seating and positioning options.

Any use that goes above and beyond this does not comply with the intended use.

### Indication / Patient Target Group / Intended Users

The special needs booster seat is for children with structural and / or functional limitations or poor head and trunk control. In addition, for people who are mentally or neurologically impaired or perceptually impaired. It ensures a stable, physiological position if a standard car seat not.

### Risks Associated with Use and Contraindications

If used properly, risks can be eliminated during use. There are no known contraindications.

## Labels / Model Identification

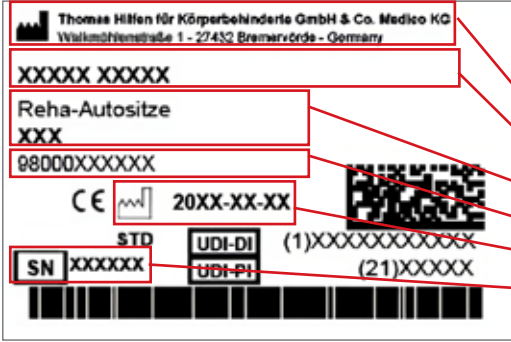
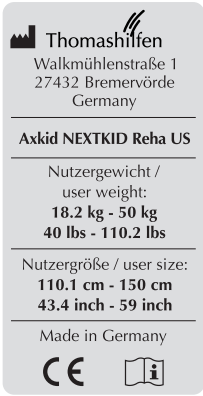
Label	Meaning
 <p>Thomas Hilfen für Körperbehinderte GmbH &amp; Co. Mediso KG Walkmühlenstraße 1 - 27432 Bremervörde - Germany</p> <p>XXXXX XXXXX</p> <p>Reha-Autositze XXX</p> <p>98000XXXXXX</p> <p>CE [mark] 20XX-XX-XX</p> <p>STD UDI-DI (1)XXXXXXXXXXXXX UDI-PI (21)XXXXXX</p> <p>SN XXXXXX</p>	<p><b>Barcode label (exchange image)</b></p> <p>Position on the product</p> <ul style="list-style-type: none"> <li>- Manufacturer</li> <li>- Product name</li> <li>- Product group</li> <li>- Item number short / long</li> <li>- Date of manufacture</li> <li>- Serial number</li> </ul>
<div data-bbox="222 691 450 949" style="border: 1px solid black; padding: 10px;"> <p>• <b>DO NOT use this Child restraint 8 years after the date of manufacture.</b></p> <p>• <b>CESSER d'utiliser ce siège d'auto pour enfant 8 ans après sa date de fabrication.</b></p> </div>	<p><b>Sticker lifetime</b></p> <p>Position on the product</p> <ul style="list-style-type: none"> <li>- Lifetime of the seat in English and French</li> </ul>
 <p>Thomashilfen Walkmühlenstraße 1 27432 Bremervörde Germany</p> <p><b>Axkid NEXTKID Reha US</b></p> <p>Nutzergewicht / user weight: <b>18.2 kg - 50 kg</b> <b>40 lbs - 110.2 lbs</b></p> <p>Nutzergröße / user size: <b>110.1 cm - 150 cm</b> <b>43.4 inch - 59 inch</b></p> <p>Made in Germany</p> <p>CE [i]</p>	<p><b>Type plate</b></p> <p>Position on the product</p> <ul style="list-style-type: none"> <li>- Manufacturer</li> <li>- Product name</li> <li>- Max. user weight / max. load capacity</li> <li>- allowable user size</li> <li>- CE mark</li> <li>- Follow the instructions for use</li> </ul>

# Labels / Model Identification

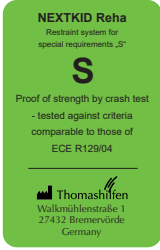
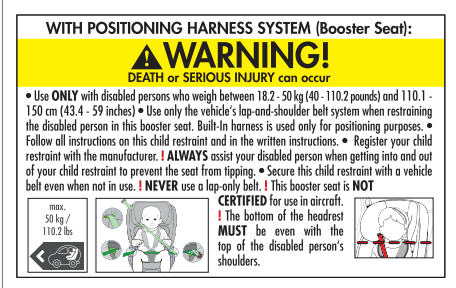
Label	Meaning
	<p><b>Crashtest-Label</b></p> <p>Position on the product information: Proof of strength by crash test - tested against criteria comparable to those of ECE R129/04</p>
<p><b>SEE INSTRUCTION MANUAL FOR COMPLETE INSTRUCTIONS AND WARNINGS</b></p> <p>This child restraint system conforms to all applicable Federal Motor Vehicle Safety Standards. <b>This Restraint is Not Certified for Use in Aircraft.</b> Child restraints could be recalled for safety reasons. You must register this restraint to be reached in a recall. Send your name, address, e-mail address if available, and the restraint's model number and manufacturing date to Thomashilfen North America, 14221 29 th STE, Unit 101, Sumner, WA. 98390, USA or call 1-866-870-2122 or register online at <a href="https://www.thomashilfen.us/registry-US">https://www.thomashilfen.us/registry-US</a></p> <p>For recall information, call the U.S. Government's Vehicle Safety Hotline at 1-888-327-4236 (TTY: 1-800-424-9153), or go to <a href="http://www.NHTSA.gov">http://www.NHTSA.gov</a>.</p>	<p><b>Recall sticker USA</b></p> <p>Position on the product - Registration of the seat explained in English</p>
	<p><b>Warning label English</b></p> <p>Position on the product</p> <ul style="list-style-type: none"> <li>- Max. User weight</li> <li>- Max. User height</li> <li>- Follow Instructions for Use</li> <li>- Direction of travel</li> </ul>

## Labels / Model Identification

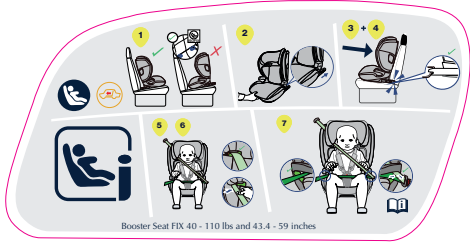
Label	Meaning
 <p>Booster Seat FIX 40 - 110 lbs and 43.4 - 59 inches</p>	<p><b>Pictogram label</b> on the left and right side</p>

## Warnings and Safety information

### **⚠ WARNING! Death or SERIOUS INJURY can occur**

**WARNING** - Read and understand all instructions and warnings in this manual, and those labeled on your child restraint carefully before first use. Failure to do so can result in the SERIOUS INJURY or DEATH of your child.

If you have difficulty reading, please have them read to you. If the copy of the Instructions for Use is missing, you can download one from [www.thomashilfen.us](http://www.thomashilfen.us).

## Certifications

This child restraint system conforms to all applicable Federal Motor Vehicle Safety Standards (FMVSS 213).

This child restraint is certified for use in passenger and multi-purpose passenger vehicles, buses and truck equipped with lap and should belt systems ONLY.

THIS RESTRAINT IS NOT CERTIFIED FOR USE IN AIRCRAFT. Aircraft seat do not have lap and shoulder belt systems which are required for use with this booster seat.

## Safety Instructions

Changes to the product are only permitted within the scope of the intended adjustment options.

All labels have to remain on the product and should not be tampered with. Check at least every 3 months that the settings on the product still work for the user's current body measurements. If you need help, have a distributor, assistive technology professional or therapist adjust the settings.

Do regular checks to make sure that the booster seat is adjusted properly to your child's needs. Check that all the nuts, bolts and screws are tightened.

Be careful of the moving parts when adjusting the product.

Never use the seat belts to lift or carry the seat. Only lift the product by its fixed components. The product only should be used by one user at a time.

The seat and the user always must be secured with the vehicle's lap and shoulder belt system. The user must always be positioned with the non load bearing positioning harness (5-point positioning harness). Make sure that the straps do not sag or twist.

Before each journey, check that the booster seat is properly secured.

Even when not occupied, this booster seat must be properly secured with the vehicle's lap and shoulder belt system. In the event of an accident, an unsecured seat can cause serious injury to the vehicle occupants.

Please note the safety standards which apply to your vehicle as outlined in the vehicle's Instructions for Use to ensure the safety of the user. The Instructions for Use have to remain with the booster seat.

If there is a serious and unexpected accident with the product, please inform our company immediately and the responsible authorities.

## WARNINGS

**⚠ WARNING! Death or SERIOUS INJURY can occur**

**ONLY use Nextkid US with children who weigh between 40 lbs and 110.2 lbs (18.2 - 50kg) AND whose height is between 43.4" and 59" (110.1 — 150cm)**

Discontinue use of this child restraint if it is older than EIGHT (8) YEARS after manufacture date.

Follow all labels on this child restraint and in these written instructions. **DO NOT INSTALL OR USE THIS CHILD RESTRAINT UNTIL YOU READ AND UNDERSTAND THE INSTRUCTIONS IN THIS MANUAL AND IN YOUR VEHICLE OWNER'S MANUAL.**

### Vehicle Seat Location

You **MUST** use the vehicle lap-and-shoulder belt system when restraining the child in this booster seat.

Use this child restraint forward facing only. Side-facing or rear-facing seats **CANNOT** be used. Refer to the vehicle owner's manual for child restraint installation for your specific vehicle.

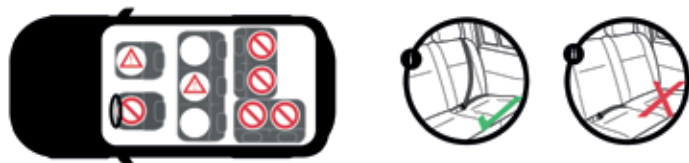

According to accident statistics, CHILDREN ARE SAFER WHEN PROPERLY RESTRAINED IN REAR VEHICLE SEATING POSITIONS THAN IN THE FRONT SEATING POSITION.

NEVER PLACE THIS CHILD RESTRAINT IN A VEHICLE SEATING LOCATION THAT HAS AN ACTIVE AIRBAG. An inflating airbag may cause serious injury or death. Refer to your vehicle owner's manual for information about airbags and child restraint installation.

This child restraint must **NOT** be used in homes, boats, buses, motorcycles, motor homes, or any other vehicles that have non-forward-facing seats, missing seat belts, or whose seat belts do not meet the requirements of this child restraint.

## Vehicle Seat Belt Systems

### **⚠️ WARNING! Death or SERIOUS INJURY can occur**

Always install this booster seat in vehicle seats with lap and shoulder belt systems. If your vehicle is equipped with an inflatable seatbelt skip using upper belt guide.

**NEVER USE** this booster seat with lap belt only, motorized, door mounted or non-locking seat belts.

**Refer to the vehicle owner's manual for vehicle seat belt use for child restraint systems.**

### **⚠️ WARNING! Death or SERIOUS INJURY can occur**

DO NOT use this child restraint if it is damaged in any way or has missing parts.

DO NOT LEAVE A CHILD RESTRAINT UNSECURED IN YOUR VEHICLE.

PARTS OF THE CHILD RESTRAINT COULD BECOME HOT ENOUGH TO BURN THE CHILD IF LEFT IN THE SUN.

DO NOT, EXCEPT AS DESCRIBED IN THESE INSTRUCTIONS, MODIFY YOUR CHILD RESTRAINT, DISASSEMBLE ANY PART OR CHANGE THE WAY THE HARNESS OR VEHICLE SEAT BELTS ARE USED. This includes any accessories or parts by other manufacturers as non-tested accessories can affect the safety of the child restraint.

DO NOT USE A CHILD RESTRAINT THAT HAS BEEN IN AN ACCIDENT OF ANY KIND.

NEVER leave children alone in a vehicle under any circumstance.

DO NOT allow children to play with this child restraint.

NO CHILD RESTRAINT CAN GUARANTEE PROTECTION WHEN THE VEHICLE IS SERIOUSLY IMPACTED.

An unoccupied Nextkid booster **MUST** be secured using vehicles lap and shoulder belt. The child restraint **MUST** be installed so that surface area is in contact with your vehicle seat.

## Product Description

### Scope of Delivery

Your product is delivered with the standard equipment and comes preassembled. Any accessories ordered along with the product are included in the box and have to be assembled subsequently. A copy of the Instructions for Use is enclosed with the product.

To store your instructions for use, there is a pocket at the backrest of the booster seat. The instructions for use must always be carried with the product.

## Installation in the vehicle

### 1. Nextkid **no** swivel and tilt base or footrest adapter with LATCH

You **MUST** use both lower anchor connection and vehicle's lap and shoulder belt to install Nextkid.

#### a) **With LATCH**

Place Nextkid onto the vehicle seat and push the LATCH release handle to extend the latch connectors. (Fig. 2) Now push LATCH into the vehicle's lower anchors until you hear them CLICK. If Lower Anchors connection is securely attached to lower anchors of your vehicle, you will see a green mark on dual locking button. (Fig. 3) Check that Axkid Nextkid connected safely to the vehicle by trying to pull it.

**IMPORTANT:** When LATCH release button showing green, LATCH is securely locked. When it is showing red it is unlocked. (Fig. 1-1)

To unlock LATCH need to press and hold the 2 latch dual locking buttons (grey) buttons on latch connectors and pull both latch unlocking devices while pulling booster seat. (Fig. 5-1)

#### b) **With vehicle's lap and shoulder belt**

Thread the shoulder portion of vehicle's lap and shoulder belt through the upper belt guide. (Fig. 5) Place both sides of the vehicle lap belt to the lower belt guides. (Fig. 6) Buckle vehicle seat belt into place. Ensure it is secure by gently pulling on it. (Fig. 7)

### 2. Nextkid **with** swivel and tilt base or footrest adapter with LATCH

You **MUST** use either lower anchor connection or stabilizing bow (if no lower anchors are available) to install Nextkid in a vehicle for stability reasons **ONLY**.

You **MUST** secure Axkid Nextkid with vehicle's lap and shoulder belt in your car. (Fig. 6-1)

#### a) **With LATCH**

Place swivel and tilt base (535) / footrest adapter (532) on your vehicle seat. Fully extend left and right Latch connectors (fig. 17) by pressing and holding the grey release buttons (Fig. 7-1).

Now guide left and right Latch into vehicle's anchor points (fig 18).

You will hear a click when locked in and see green marks on each side of connectors (Fig. 19).

Place Nextkid centered onto swivel and tilt base/ footrest adapter so that stopper will slide into groove under Nextkid seat (Fig. 20). Then press booster seat down to swivel and tilt base/ footrest adapter so that hook and loop fastener attaches seat to the base (Fig. 21). Now you can push swivel and tilt base/ footrest adapter backwards until it will flush to vehicle's backrest (Fig. 9-1).

Ensure that Nextkid is connected safely to the vehicle by trying to pull it.

Securing booster seat: Thread the shoulder portion of vehicle's lap and shoulder belt through the upper belt guide. (Fig. 5) Place both sides of the vehicle lap belt to the lower belt guides. (Fig. 6) Buckle vehicle seat belt into place. Ensure it is secure by gently pulling on it. (Fig. 7)

#### b) **With stabilizing bow (If no LATCH is available)**

To stabilize Nextkid with swivel and tilt base/ footrest adapter in your vehicle you must install stabilizing bow. It can be installed in gap between seat and back of vehicle with bent end up or down depending on your vehicle seat (Fig. 10-1 + 11-1). Choose direction offering most stability (Fig. 23).

Securing booster seat: Thread the shoulder portion of vehicle's lap and shoulder belt through the upper belt guide. (Fig. 5) Place both sides of the vehicle lap belt to the lower belt guides. (Fig. 6) Buckle vehicle seat belt into place. Ensure it is secure by gently pulling on it. (Fig. 7)

Place swivel and tilt base (535)/ footrest adapter (532) on your vehicle seat. Fully retract left and right Latch connectors (Fig. 17) by pressing and holding the grey release buttons (Fig. 7-1) and pulling them to you.

Insert stabilizing bow into brackets (Fig. 24) and tighten 2 setscrews so that you are still able to adjust stabilizing bow. Guide base with stabilizing bow in gap between seat and back of vehicle (Fig. 25).

Place Nextkid centered onto swivel and tilt base/ footrest adapter so that stopper will slide into groove under Nextkid seat (Fig. 20). Then press booster seat down to swivel and tilt base/ footrest adapter so that hook and loop fastener attaches seat to the base (Fig. 21). Now you can push swivel and tilt base/ footrest adapter backwards until it will flush to vehicle's backrest (Fig. 9-1).

Hold swivel and tilt base/ footrest adapter tight with one hand and with other pull booster seat forward to get it loose from hook and loop fastener and put seat to the side. Now you can reach 2 setscrews to tighten stabilizing bow (Fig. 26).

Place Nextkid centered onto swivel and tilt base/ footrest adapter so that stopper will slide into groove under Nextkid seat (Fig. 20) again. Then press booster seat down to swivel and tilt base/ footrest adapter so that hook and loop fastener attaches seat to the base (Fig. 21).

Check that booster's back will flush your vehicle's seat back (Fig. 9-1).

### **⚠ WARNING! Death or SERIOUS INJURY can occur**

**DO NOT** use this booster seat if it can't be properly leveled, stabilized, and installed as per this instruction manual.

It is possible that your vehicle has no suitable seating position for this booster seat due to seating surface, seat belt type and/or airbag system. Read and follow these instructions, and your vehicle owner's manual carefully.

You **MUST** use the vehicle 3-point lap-and-shoulder belt when restraining the child in the booster seat.

Vehicle belts **MUST** be tight, adjusted to the child's body, and should not be twisted.

**NEVER** use a vehicle lap-only belt to secure child in booster seat.

**NEVER USE A LOOSE SHOULDER BELT.**

**Lap portion of lap-and-shoulder belt MUST be low and snug across the hips, with the pelvis firmly engaged, just touching the child's thighs.** The lap portion **MUST NOT** be lying across the child's stomach as this can cause major injuries to the child in case of a sharp turn, sudden stop or crash.

**DO NOT** position vehicle belt over top of the armrests.

The vehicle seat headrest should not create a gap between vehicle seat and booster seat. If so, remove the vehicle headrest.

**DO NOT** use any load bearing contact points other than those described in the instructions and marked in the child restraint.

The 5-point belt (built-in harness) integrated into the child seat is used as an positioning belt for disabled children in Booster Mode and is NOT a safety-relevant item. In this case the child is restrained by the vehicle's 3-point safety belt. The 5-point belt (built-in harness) is only intended for use as a positioning belt to provide additional support for disabled children with a body weight between 18,2 and 50 kg / 40 and 110.2 lbs and body height between 110.1 and 150 cm/ 43.4 and 59".

## Securing a child in the booster seat

1. To loosen 5-point positioning harness press harness adjuster pull chest strap towards you. Repeat this for the other side. (Fig. 12)
2. Unbuckle chest clip and positioning harness by pressing red buckle release button (Fig. 13) and by pulling the buckle clips out. Move harness straps to the side.
3. Place child in the booster seat with child's back flat against back of the backrest.
4. Adjust headrest height so that bottom will be even or just above (3/4 inch) top of child's shoulders.
5. Place harness straps over child's shoulders and insert buckle clips until they 'click' into place. (Fig. 14) ENSURE that harness clips and buckle are properly fastened by gently tugging on each. ENSURE that the straps are not twisted.
6. Tighten positioning harness by gently pulling the harness adjuster straps until all slack is removed. Adjust chest clip and to arm pit level away from your child's neck and buckle chest clip. ENSURE straps are flat and snug against child's shoulders on thighs.
7. Guide the shoulder section of the vehicle's lap and shoulder belt through the upper belt guide (Fig. 5)
8. Guide both sides of vehicle lap belt under both arm rests. The diagonal portion is also under the arm rest. (Fig. 15 + 16) ENSURE that shoulder belt lies across child's shoulder and chest, and NOT touching child's face or neck.
9. Buckle vehicle seat belt into place and ensure it is secure by gently pulling on it. (Fig. 17) The lap belt portion MUST be routed under both arm rests. (Fig. 18) ENSURE that seat buckle is on the outside of lower belt guide. (Fig. 17)

## Removing child from booster seat

1. Unbuckle vehicle seat belt and unthread vehicle lap and shoulder belt from armrests
2. Open chest clip by pressing in pin clips while pulling apart the two piece chest clip.
3. Loosen the 5-point harness by pressing harness adjuster and pull chest strap towards you. Repeat this for the other side. (Fig. 12)
4. Unbuckle harness by pressing on RED buckle release button.

## Seat adjustments

(Fig. 8) Pull the headrest height adjusting handle upwards to proper height adjustment. The shoulder harness must be **EVEN OR SLIGHTLY ABOVE** the child's shoulders.

(Fig. 9) Release handle when height is correct. Check if headrest is in locked position.

(Fig. 10) Pull both (left and right) SIP bumper controllers to unlock width adjustment. Then move side wings to desired width (best fit of your child). Each side can be adjusted separately. If adjustment is done lock left and right SIP bumper controllers again.

## Removing the booster seat out of your vehicle

To remove the Nextkid from vehicle, press left and right LATCH unlocking device (grey) buttons and pull left and right LATCH dual locking buttons to release Nextkid from vehicle lower anchors and lift seat out of vehicle. (Fig. 5-1)

## Product Description

### Scope of Delivery

Your product is delivered with the standard equipment and comes preassembled. Any accessories ordered along with the product are included in the box and have to be assembled subsequently. A copy of the Instructions for Use is enclosed with the product.

To store your instructions for use, there is a pocket at the backrest of the booster seat. The instructions for use must always be carried with the product.

### Standard Equipment

Back with integrated height adjustable headrest; breathable upholstery with flame-retardant cover fabric; head rest cushion, back cushion, pelvic cushion, seat cushion, chest clip; crotch pad; 5-point belt including strap soft pads; belt guide for 3-point vehicle belt; back stabilizer; side impact protectors; prepared mounting options for all accessories; removable covers, machine washable up to 105° F; tested according FMVSS 213.

### Booster Assembly

Carefully remove the transport protection and the packaging. Keep the packaging material and small parts out of the reach of children to prevent swallowing or choking.

Before installation in a vehicle, ensure that the measurements are correctly adjusted to the user.

Please determine user measurements:

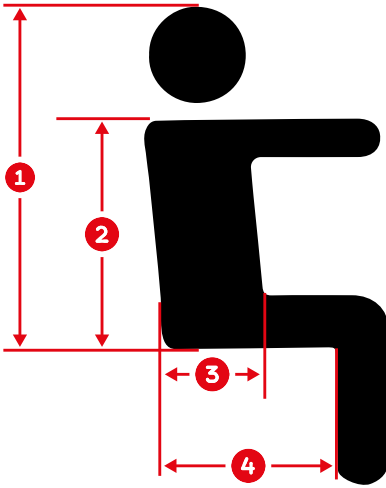

- ① Seat to head
- ② Shoulder height
- ③ depth behind crotch strap
- ④ Seat depth

Needed Seat to head

Needed Shoulder height

Needed Seat depth

Needed depth behind crotch strap

## Technical Data

### Nextkid US

Seat depth (behind crotch strap)	23 cm / 9.1"
Seat depth	37 cm / 14.5"
Seat width	22 - 29 cm / 8.7 - 11.4"
Back height (seat inside)	55 - 75 cm / 21.7 - 29.5"
Shoulder height (harness guide)	32 - 52 cm / 12.6 - 20.4"
Shoulder width	36 - 42 cm / 14.2 - 16.5"
Overall dimensions (w x h x d)	44 x 62 x 48 cm / 17.3 x 24.4 x 18.9"
Weight of the seat	8.5 kg / 18.7 lbs
User height (min. - max.)	110.1 - 150 cm / 43.4 — 59"
User weight (min. - max.)	18,2 - 50 kg / 40 — 110.2 lbs

## Accessories

**LATCH connectors are for stability options only and not a safety device. Nextkid booster must always be secured with vehicle's lap and shoulder belt, even when unoccupied. (532 & 535)**

### Footrest adapter incl. Latch (Fig. 27) (532)

The Nextkid is clipped onto the footrest adapter. To attach the seat in the correct position, make sure that the recess at the back of the adapter plate is pushed against the cylindrical stop. As soon as you use this accessory, the Isofix of the accessory is used instead of the Isofix of the Nextkid for stability only. Latch connectors are for stability options only and not a safety device. Nextkid booster must always be secured with vehicle's lap and shoulder belt, even when unoccupied.

**For more details see assembly instruction.**

### Swivel — Tilting base (right turning) incl. Latch (Fig. 28) (535)

With the swivel - tilting function, the rehab car seat can be tilted up to 10° and swiveled towards the vehicle door. To do this, press the red release lever and turn the seat towards the door. This makes it easier for carers to transfer the user and access the 5-point harness belt buckle. Attach the swivel function under the adapter plate of the rehab seat. Latch connectors are for stability options only and not a safety device. Nextkid booster must always be secured with vehicle's lap and shoulder belt, even when unoccupied.

**For more details see assembly instruction.**

**Stabilizing bow (if vehicle has no Latch)** (Fig. 10-1) (536)

Recommended for stability when using footrest adapter (532) / swivel and tilt base (535) and vehicle has no latch.

**For more details see assembly instruction.**

**Footrest, foldable** (Fig. 29) (537)

The footrest provides support for the user's feet. The footrest is folded up for getting in and out of the booster seat. A magnet secures this position of the footrest. The footrest is pushed into the holder from the front. Adjust the depth of the footrest to the seat in the vehicle. Screw the footrest to the sides of the carrier using the screws provided.

The desired angle can be set using the red eccentric levers on both sides. Ensure that the eccentric levers are firmly tightened after adjustment. Select the height of the footrest legs so that they support the rehab seat securely in the footwell of the vehicle. The height can be adjusted using the side screws. Ensure that the Allen screws are present on the footrest. The final adjustment is made by adjusting the footrest feet. It is essential to lock the threaded rod with the plastic lock nuts!

If the footrest is not at the correct height for the user, loosen the screws on both sides of the footrest. Adjust the height and retighten the screws.

**For more details see assembly instruction.**

**Front stand** (stability option, if no footrest is used) (Fig. 30) (538)

The support leg provides support for the rehab seat in the footwell of the vehicle. The support leg is pushed into the holder from the front. Adjust the depth of the support leg to the seat in the vehicle. Tighten the support leg with the enclosed screws. The desired angle can be set using the red eccentric levers on both sides. Ensure that the eccentric levers are firmly tightened after adjustment.

Select the height of the support legs so that the rehab seat is securely supported in the footwell of the vehicle. The height can be adjusted using the threaded rods. It is essential to lock the threaded rod with the plastic adjuster after adjusting the height.

**For more details see assembly instruction.**

**Anterior support table** (Fig. 31) (528)

The lower arm support is placed on the side elevations of the rehab seat. The short harnesses on the sides of the table are routed to the rear and attached to the D-rings of the 5-point harness. The downward-facing straps are attached to the fleece strips on the seat shell. Then adjust the belt length so that your child can make good use of the underarm support and it does not pinch your child.

### **Adjustable abduction block** (Fig. 32), rigid (539)

The abduction guide is attached to the adapter plate and can be adjusted in height and depth. It can only be used in combination with the adapter plate.

**NOTE:** The adjustable abduction block can not be used with seat depth extender.

### **Seat depth extension** (Fig. 33) (540)

The seat depth extension is used to extend the seat surface for taller users and thus maximise seating comfort. The seat depth extension is attached to the adapter plate and can be mounted at any depth. It can only be used in combination with the adapter plate.

### **Seat wedge** (Fig. 34) (810)

The seat wedge is positioned below the car seat. The high edge is at the front to achieve an optimum rest position of the child.

The cover can be removed (zipper) and washed in the machine at up to 30° C / 86° F.

**Please note:** Seat wedge below and swivel base should not be used together.

### **Abduction block, soft padded** (Fig. 35, 36, 37) (358)

The abduction block supports the positioning of the legs and prevents them from crossing. The strap of abduction block is going into the hole of crotch strap (Fig. 35) and guided under upholstery and foam pad to the slit in front of the seat. (Fig. 36) Clip the strap to push button on abduction block. (Fig. 37)

### **Cushion, leveling & protection** (Fig. 22) (513)

Place the cushion under the Axkid NEXTKID Rehab US booster seat onto the vehicle seat. (Fig. 42) It is used to compensate for the shape of the vehicle seat. In some car seat models, there is little direct contact surface for the Axkid NEXTKID Rehab US, which can cause damage to the car seat, especially when the seat is swiveling. To minimize this risk, the cushion compensates for the shape of the seat.

## Cleaning, Maintenance, and Repair

### Cleaning, Care Instructions, and Disinfection on a Daily Basis

#### Padding

The padding can be easily removed in a few simple steps and washed separately. The padding consists of a fabric cover and sometimes fillers made of foam. Check if the padding has a zipper or a hook and latch fastener. If it does, open the padding and remove the foam filler before washing the cover. Please also note the following care instructions.

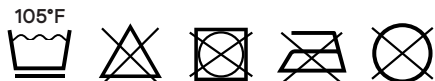

We would like to point out that even high-quality materials can fade as a result of long and intense exposure to sunlight or frequent washing.

#### Hook and Loop Fasteners

To keep the hook and loop fasteners working well, clean them now and then with a brush. Always close or cover the hook and loop fasteners before washing.

#### Plastic Parts

The plastic parts on the product can be cleaned and disinfected with standard soap (neutral soap).

#### Metal Parts

The metal parts on the product can be cleaned and disinfected with standard soap (neutral soap).

#### Disinfection

Clean the padding, plastic parts, and metal parts before disinfecting. Damp wipe all the plastic and metal parts on the product with disinfectant. Only water-based products should be used. When disinfecting note the directions from the manufacturer in question.

The padding and the covers have to be disinfected before reusing. To do so use the right detergent in keeping with the guidelines of the Association of Applied Hygiene VAH.

#### Spare Parts

Only original spare parts should be used for repairs. A list of the spare parts is available at [www.thomashilfen.us](http://www.thomashilfen.us). To receive the correct spare parts or for possible technical recalls, we normally require the serial number. (See page 16 to 18 Labels) Removal / installation of spare parts should only be done by qualified staff! In the event of returns, please make sure the product is securely packaged for transportation.

## Storage

Store the product in a safe place when it is not being used. Do not lay or put any heavy objects on the product while it is being stored. Protect the product from weather like rain, intense sunlight, and frost. If the product is wet, wipe the metal and plastic parts dry and let the padding dry before storing the product.

## Disposal

If the product is no longer usable due to its condition or it has reached the end of its service life, it can be recycled at the local waste disposal company. Please refer to the local guidelines for recycling and disposal.

## Technical standards and CE marking

Nextkid US meets the requirements of FMVSS 213 and has a proof of strength certificate in accordance with the UN standard ECE R 129 and is provided with a CE marking.

## Warranty

### Limited 2-years warranty

This child restraint is warranted against defective materials and workmanship for two years from the date of original purchase. Thomashilfen will, at its option, provide replacement parts for this product or replace this product. Thomashilfen reserves the right to discontinue or change fabrics, parts, models or products, or to make substitutions.

### Warranty Limitations

This warranty does not include damages which arise from negligence, misuse, or use not in accordance with this instruction manual. The use of non-Thomashilfen branded covers, inserts, toys, accessories or tightening devices is not approved by Thomashilfen. Their use could cause this child restraint to fail federal safety standards or perform worse in a crash. Their use automatically voids the Thomashilfen warranty.

### Limitations of Damages

The warranty and remedies as set forth above are exclusive and in lieu of all others, oral or written, express or implied. In no event will Thomashilfen or the retailer selling this product be liable to you for any damages, including incidental or consequential damages, or loss of use arising out of the use or inability to use this product.

PLEASE REGISTER THIS CHILD RESTRAINT WITHIN 30 DAYS OF PURCHASE TO EXPEDITE WARRANTY CLAIMS AND TO VERIFY ORIGINAL DATE OF PURCHASE.

## Period of Use

The product has a period of use of up to 8 years if used correctly as per the information in this manual.

The period of use does not apply to wear parts like padding, covers, etc.

## Distributor



### **Thomashilfen North America**

14221 29th St E, #101

Sumner, WA 98390

phone: 866 870 2122 (toll free in U.S.)

[www.thomashilfen.us](http://www.thomashilfen.us)

[info@thomashilfen.com](mailto:info@thomashilfen.com)



Thomas Hilfen für Körperbehinderte GmbH & Co. Medico KG  
Walkmühlenstraße 1 • 27432 Bremervörde • Germany  
Phone: +49 (0) 4761 8860 • Fax: +49 (0) 4761 886-19  
E-Mail: [info@thomashilfen.de](mailto:info@thomashilfen.de) • [www.thomashilfen.de](http://www.thomashilfen.de)